

Instructions of Networking Configuration for Data Logger (WiFi)

1. Open a wireless network.
2. Select logger network (network name: AP+SN) and connect. The password can be found on the logger label, which are the characters behind PWD. The built-in logger does not need a password and is connected directly.

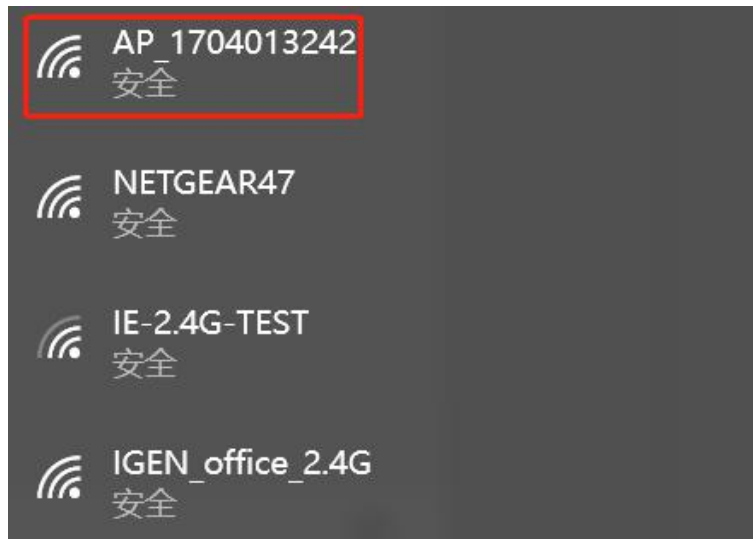

3. Open a browser and enter 10.10.100.254. Both username and password are admin. (Recommended browser: IE 8+, Chrome 15+, Firefox 10+.)

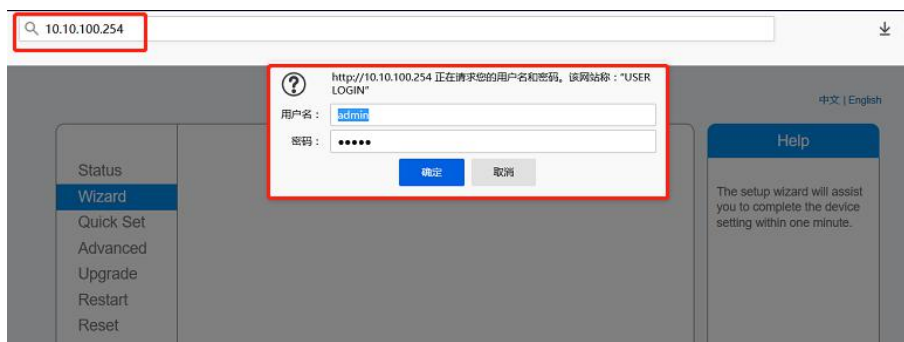

4. Go to logger setup page. The basic information are listed here.



中文 | English

Status	<p>- Inverter information</p> <p>Inverter serial number ---</p> <p>Firmware version (main) ---</p> <p>Firmware version (slave) ---</p> <p>Inverter model ---</p> <p>Rated power --- W</p> <p>Current power --- W</p> <p>Yield today --- kWh</p> <p>Total yield --- kWh</p> <p>Alerts ---</p> <p>Last updated ---</p> <p>- Device information</p> <p>Device serial number 1704013242</p> <p>Firmware version LSW3_14_FFFF_1.0.23</p> <p>Wireless AP mode Enable</p> <p>SSID AP_1704013242</p> <p>IP address 10.10.100.254</p> <p>MAC address 9C:D8:63:71:8D:B0</p> <p>Wireless STA mode Disable</p> <p>Router SSID</p> <p>Signal Quality</p> <p>IP address</p> <p>MAC address</p> <p>- Remote server information</p> <p>Remote server A Not connected</p> <p>Remote server B Not connected</p>	Help
--------	---	------

Web Ver:1.0.24

5. Go to setup guide, click Refresh to search the wireless network. Select the target network and connect.

Status	<p>Please select your current wireless network:</p> <table border="1"> <tr> <td><input checked="" type="radio"/> IE-2.4G-TEST</td> <td>54:A7:3:70:99:13</td> <td>82</td> <td>1</td> </tr> <tr> <td><input type="radio"/></td> <td>0:BE:D5:20:B8:2C</td> <td>80</td> <td>1</td> </tr> <tr> <td><input type="radio"/> AP_1753738492</td> <td>30:EA:E7:36:B:36</td> <td>78</td> <td>2</td> </tr> <tr> <td><input type="radio"/> IGEN_office_2.4G</td> <td>0:BE:D5:20:B8:2A</td> <td>76</td> <td>1</td> </tr> <tr> <td><input type="radio"/> IGENTEST</td> <td>E8:65:D4:F2:15:B8</td> <td>74</td> <td>6</td> </tr> <tr> <td><input type="radio"/></td> <td>90:5D:7C:97:95:29</td> <td>74</td> <td>1</td> </tr> <tr> <td><input type="radio"/> IGEN_office_2.4G</td> <td>90:5D:7C:97:95:27</td> <td>72</td> <td>1</td> </tr> <tr> <td><input type="radio"/></td> <td>90:5D:7C:97:C9:E5</td> <td>72</td> <td>1</td> </tr> <tr> <td><input type="radio"/> AP_1719065936</td> <td>30:EA:E7:36:CF:B2</td> <td>70</td> <td>1</td> </tr> <tr> <td><input type="radio"/> IGEN_office_2.4G</td> <td>90:5D:7C:97:C9:E3</td> <td>70</td> <td>1</td> </tr> <tr> <td><input type="radio"/> TEST*** ? = , ;</td> <td>4A:E:EC:9E:C3:3E</td> <td>70</td> <td>11</td> </tr> <tr> <td><input type="radio"/> IGEN_office_2.4G</td> <td>0:BE:D5:20:B7:EE</td> <td>66</td> <td>11</td> </tr> <tr> <td><input type="radio"/> AD R4707F66R</td> <td>08:D8:A3:76:BA:24</td> <td>66</td> <td>11</td> </tr> </table> <p>*Note: When RSSI of the selected WiFi network is lower than 15%, the connection may be unstable, please select other available network or shorten the distance between the device and router.</p> <p style="text-align: center;">Refresh</p> <p>Add wireless network manually:</p> <p>Network name (SSID) (Note: case sensitive) <input type="text" value="IE-2.4G-TEST"/></p> <p>Encryption method <input type="text" value="WPA2PSK"/></p> <p>Encryption algorithm <input type="text" value="AES"/></p> <p style="text-align: center;">Next</p> <p style="text-align: center;">1 2 3 4</p>	<input checked="" type="radio"/> IE-2.4G-TEST	54:A7:3:70:99:13	82	1	<input type="radio"/>	0:BE:D5:20:B8:2C	80	1	<input type="radio"/> AP_1753738492	30:EA:E7:36:B:36	78	2	<input type="radio"/> IGEN_office_2.4G	0:BE:D5:20:B8:2A	76	1	<input type="radio"/> IGENTEST	E8:65:D4:F2:15:B8	74	6	<input type="radio"/>	90:5D:7C:97:95:29	74	1	<input type="radio"/> IGEN_office_2.4G	90:5D:7C:97:95:27	72	1	<input type="radio"/>	90:5D:7C:97:C9:E5	72	1	<input type="radio"/> AP_1719065936	30:EA:E7:36:CF:B2	70	1	<input type="radio"/> IGEN_office_2.4G	90:5D:7C:97:C9:E3	70	1	<input type="radio"/> TEST*** ? = , ;	4A:E:EC:9E:C3:3E	70	11	<input type="radio"/> IGEN_office_2.4G	0:BE:D5:20:B7:EE	66	11	<input type="radio"/> AD R4707F66R	08:D8:A3:76:BA:24	66	11	Help
<input checked="" type="radio"/> IE-2.4G-TEST	54:A7:3:70:99:13	82	1																																																			
<input type="radio"/>	0:BE:D5:20:B8:2C	80	1																																																			
<input type="radio"/> AP_1753738492	30:EA:E7:36:B:36	78	2																																																			
<input type="radio"/> IGEN_office_2.4G	0:BE:D5:20:B8:2A	76	1																																																			
<input type="radio"/> IGENTEST	E8:65:D4:F2:15:B8	74	6																																																			
<input type="radio"/>	90:5D:7C:97:95:29	74	1																																																			
<input type="radio"/> IGEN_office_2.4G	90:5D:7C:97:95:27	72	1																																																			
<input type="radio"/>	90:5D:7C:97:C9:E5	72	1																																																			
<input type="radio"/> AP_1719065936	30:EA:E7:36:CF:B2	70	1																																																			
<input type="radio"/> IGEN_office_2.4G	90:5D:7C:97:C9:E3	70	1																																																			
<input type="radio"/> TEST*** ? = , ;	4A:E:EC:9E:C3:3E	70	11																																																			
<input type="radio"/> IGEN_office_2.4G	0:BE:D5:20:B7:EE	66	11																																																			
<input type="radio"/> AD R4707F66R	08:D8:A3:76:BA:24	66	11																																																			

6. Enter the password and click Next.



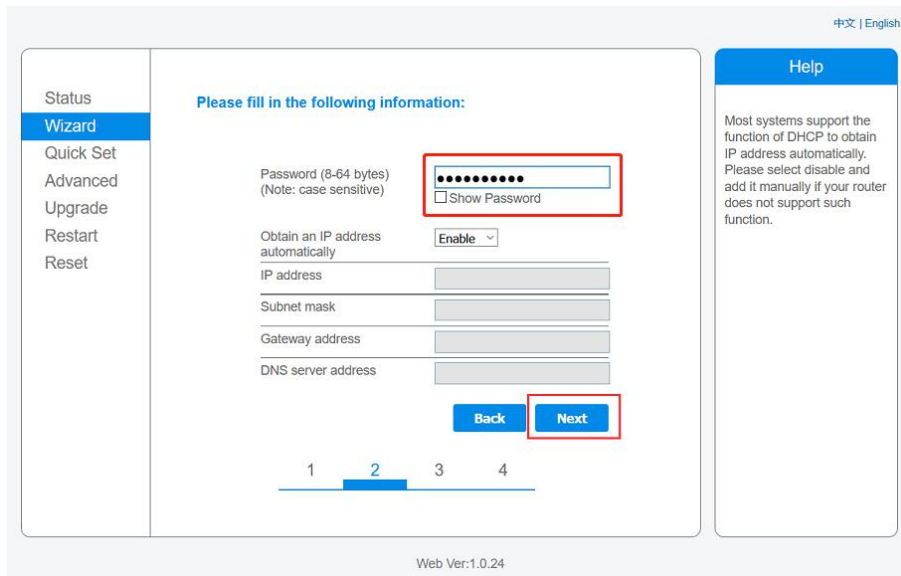

7. Users can select any options below to enhance the security and click Next.

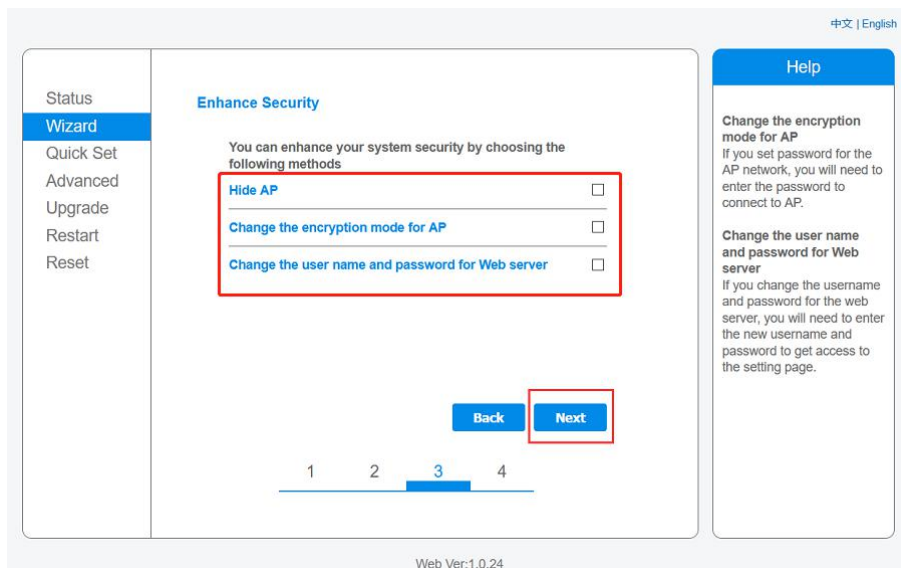

8. If the setup is successful, the following page will pop up and click OK to reboot the module.





9. Log in to 10.10.100.254 again and check system info here. After the network setting is done, wireless network STA mode is Enable. The info of router will be displayed on the page and the remote server A is connectable.

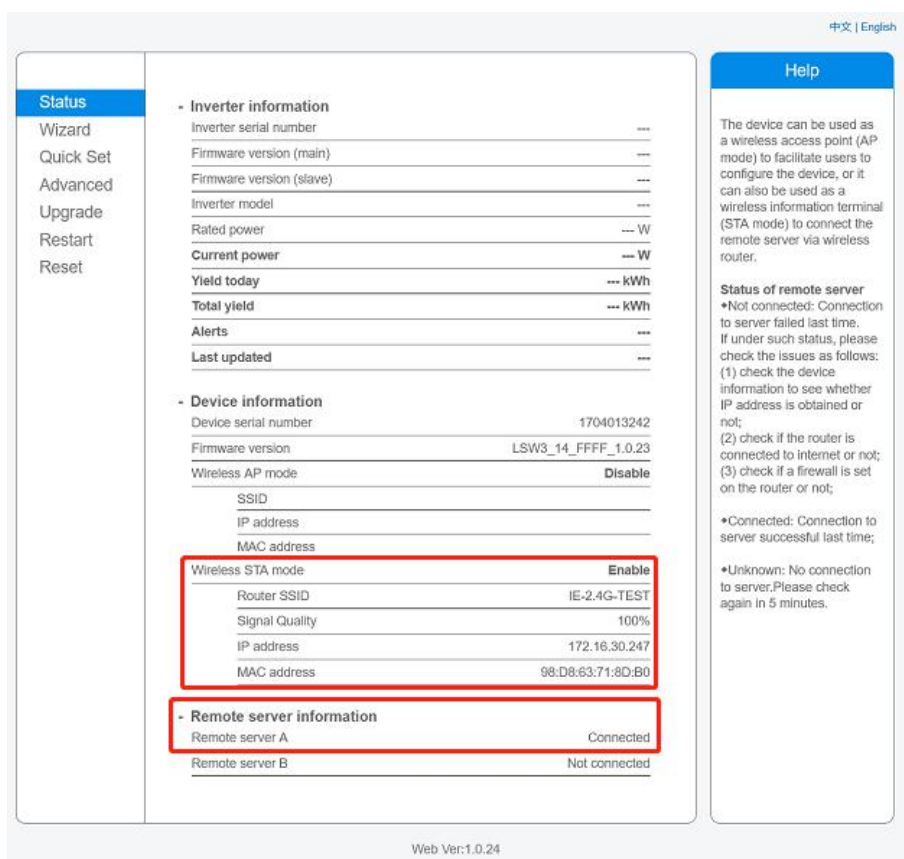

10. If the remote server is disconnectable, please refresh the page or try it again.

